

SPECIFICATIONS:

FREQUENCY (GHz)	DC - 40
VSWR (MAX)	DC - 40: 1.4:1
VSWR WOW (MAX)	DC - 40: 0.05
INSERTION LOSS (dB)	DC - 18: 0.4 MAX (0.3 TYP) 18 - 26.5: 0.75 MAX (0.5 TYP) 26.5 - 40: 1.0 MAX (0.75 TYP)
INSERTION LOSS WOW (dB, MAX)	DC - 40: 0.05
POWER (PEAK):	500 W @ 1.0 GHz
POWER (AVG):	50 W @ 1.0 GHz
CURRENT (MAX):	3 A DC
TEMPERATURE:	-40 °C TO +85 °C
ROTATIONAL SPEED (RPM, MAX)	200
TORQUE (IN OZ, MAX)	1 @ 23 °C
WEIGHT	1.2 OZ (EST)

MATERIAL: PRIMARILY STAINLESS STEEL UNS-S30300 PER ASTM A582

FINISH: PASSIVATE PER SAE-AMS2700 OR ASTM-967 (ROHS COMPLIANT)

MARKING: DIAMOND ANTENNA STANDARD LABEL WITH MODEL NO., SER. NO. & CODE IDENT.

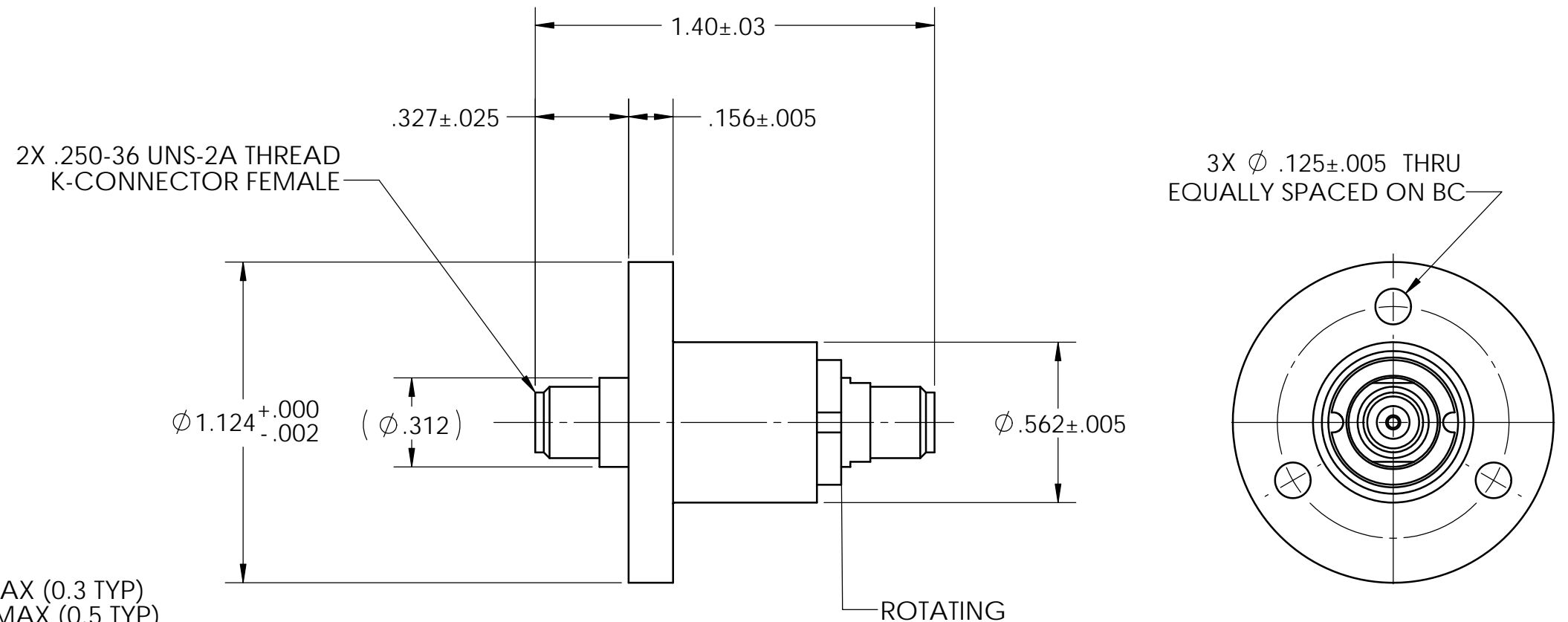

THIRD ANGLE PROJECTION

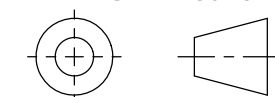

DIMENSIONS ARE IN INCHES. REMOVE ALL BURRS AND SHARP EDGES .005 MAX, UNLESS OTHERWISE SPECIFIED, SURF FINISH 63 TOLERANCES ARE:
FRACTIONS ±1/64
DECIMALS 2 PLACES ±.03
ANGLES ±1/2°
 3 PLACES ±.010

INTERPRET DIMENSIONS & TOLERANCES PER ASME Y14.5M

DIAMOND ANTENNA & MICROWAVE CORP

LITTLETON, MA 01460

TITLE:

40 GHz K-CONNECTOR ROTARY COUPLER

SIZE:

B

CAGE CODE:

01882

DRAWING NUMBER:

CAT 17-2150-0

SCALE

2:1

WEIGHT (EST.):

SHEET **1 OF 1**