

DESIGN SPECIFICATIONS

ELECTRICAL	CHANNEL #1	CHANNEL #2
	FREQUENCY (GHz):	DC-4.5
VSWR (MAX):	1.50:1	2.00:1
VSWR WOW (MAX):	0.05	0.25
INSERTION LOSS (MAX):	0.50dB	1.0 dB
WOW (MAX):	0.05dB	0.25dB
POWER, AVERAGE (MIN):	5W	5W
ISOLATION (MIN):	<-----40 dB----->	
MECHANICAL		
ROTATIONAL SPEED (MAX):	300 RPM	
TORQUE (MAX):	8 oz.-in.	
WEIGHT:	5 oz.	
CHANNEL MARKING:	1/8 BLACK CHARACTERS (MARK BOTH ENDS)	
LABEL:	DIAMOND STANDARD LABEL LOCATED WHERE SHOWN TO INCLUDE P/N, S/N (XXXX) AND DATE CODE YYYY-MM-DD	
MATERIAL:	ALUMINUM ALLOY AND STAINLESS STEEL	
FINISH:	CHROMATE CONV. COATING & PASSIVATE ROHS COMPLIANT	

THIRD ANGLE PROJECTION

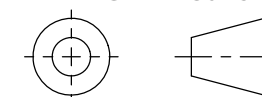

DIMENSIONS ARE IN INCHES. REMOVE ALL BURRS AND SHARP EDGES .005 MAX, UNLESS OTHERWISE SPECIFIED, SURF FINISH 63 TOLERANCES ARE:

FRACTIONS	DECIMALS	ANGLES
±1/64	2 PLACES ±.03	±1/2°
	3 PLACES ±.010	

INTERPRET DIMENSIONS & TOLERANCES PER ASME Y14.5M

DIAMOND ANTENNA & MICROWAVE CORP

LITTLETON, MA 01460

TITLE:

DUAL CHAN ROTARY COUPLER, SMA

SIZE:

B

CAGE CODE:

01882

DRAWING NUMBER:

CAT 23-2244A-0

SCALE 2:1

WEIGHT (EST.):

SHEET 1 OF 1