

4X ϕ .140 THRU ALL
EQ SP AS SHOWN ON B.C.

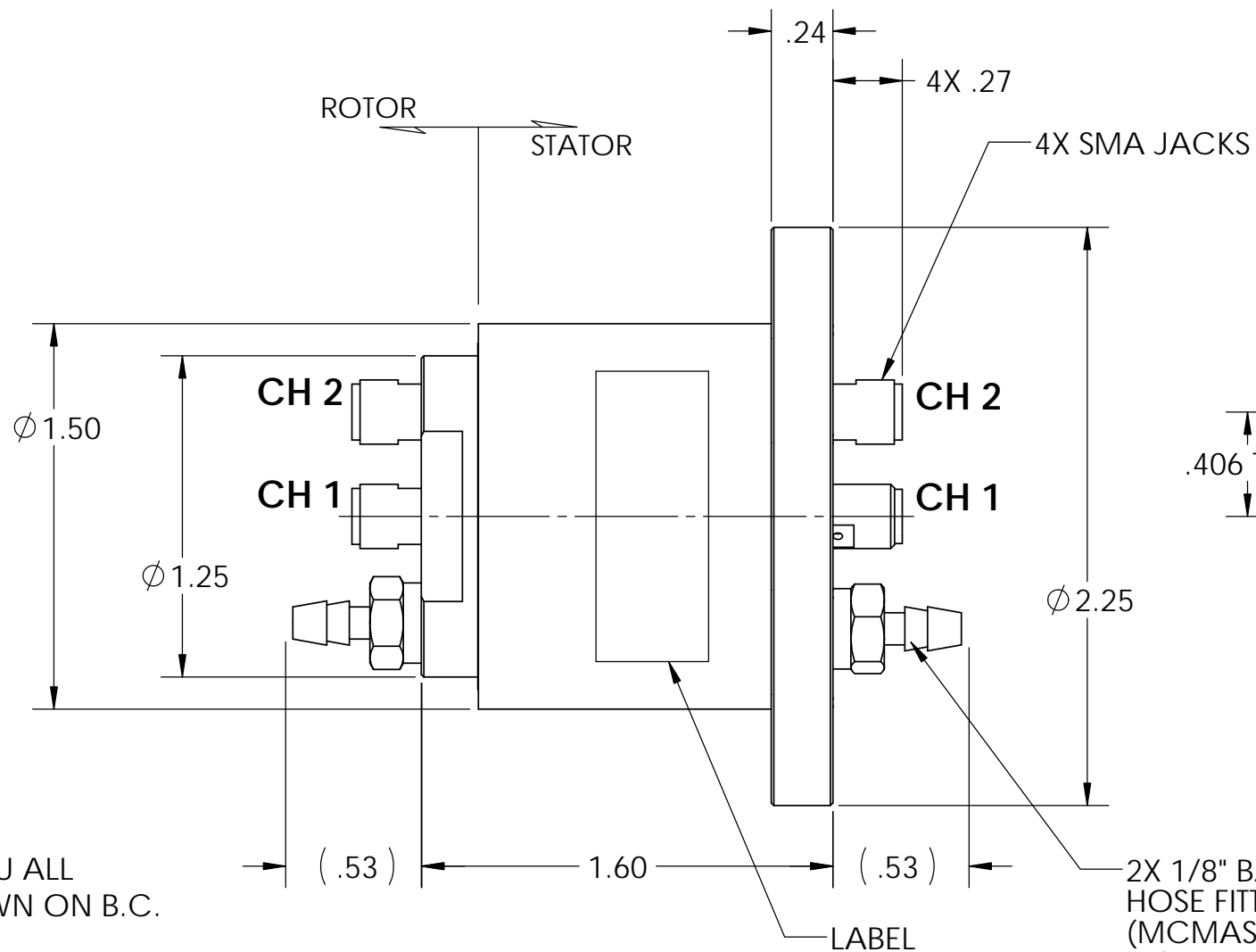

2X 1/8" BARBED
HOSE FITTINGS
(MCMaster CARR
P/N 2844K13)

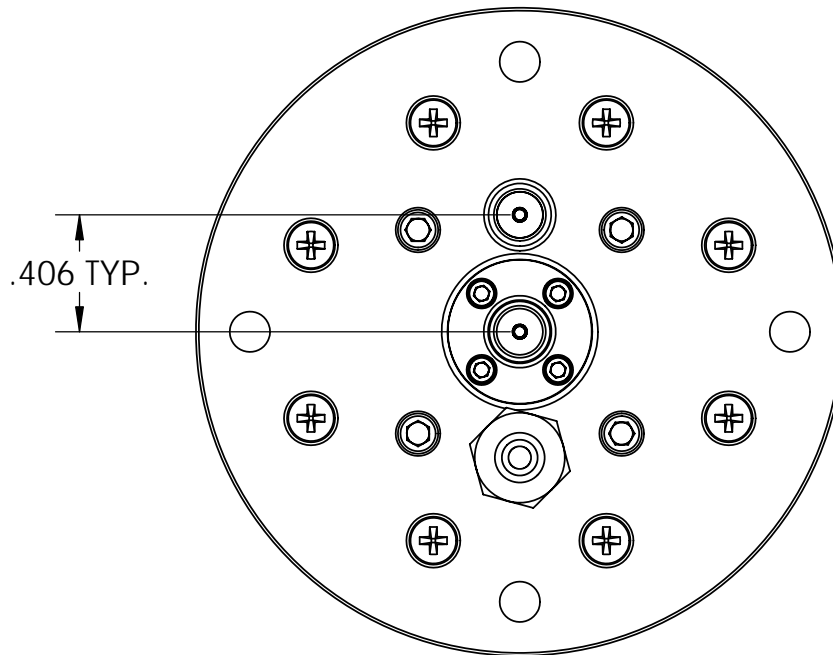

DESIGN SPECIFICATIONS

ELECTRICAL	CHAN 1 (INNER)	CHAN 2 (OUTER)
FREQUENCY (GHz):	DC - 12	DC - 2.4
VSWR (MAX):	1.5:1 (DC-2.4) 2.0:1 (2.5-12)	1.5:1
INSERTION LOSS (dB MAX):	0.4	0.5
POWER, PEAK:	3 KW	3 KW
POWER, AVERAGE:	20 W (CW) @ 1 GHz	20 W (CW) @ 1 GHz
CHAN ISOLATION (MIN):	50 dB	50 dB

MECHANICAL & ENVIRONMENTAL

ROTATIONAL SPEED:	100 RPM
LEAKAGE:	3 CC/MIN
PRESSURE:	2 PSIG
TORQUE:	50 OZ-IN MAX
MATERIAL:	ALUMINUM AND NON-CORROSIVE SST PER MIL SPECS
FINISH:	CHROMATE CVRSN PER MIL-DTL-5541, CL 3, TYPE 2 AND PASSIVATION PER ASTM-A967
MARKING:	LABEL IN AREA INDICATED SHALL INCLUDE AS A MINIMUM: DIAMOND LOGO, P/N, SERIAL NO.

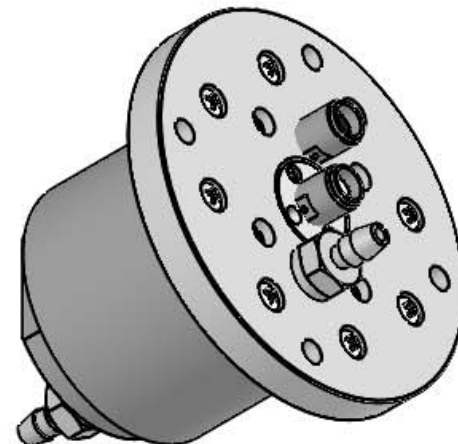

ROHS COMPLIANT

THIRD ANGLE PROJECTION

DIAMOND ANTENNA & MICROWAVE CORP
LITTLETON, MA 01460

TITLE:

DUAL CHAN ROTARY COUPLER, SMA

DIMENSIONS ARE IN INCHES.
REMOVE ALL BURRS AND
SHARP EDGES .005 MAX,
UNLESS OTHERWISE
SPECIFIED, SURF FINISH 63
TOLERANCES ARE:
FRACTIONS **DECIMALS** **ANGLES**
 $\pm 1/64$ $2 \text{ PLACES } \pm .03$ $\pm 1/2^\circ$
 $3 \text{ PLACES } \pm .010$

SIZE:

B

CAGE CODE:

01882

DRAWING NUMBER:

CAT 52-2244A-0

INTERPRET DIMENSIONS &
TOLERANCES PER ASME Y14.5M

SCALE

3:2

WEIGHT (EST.):

SHEET **1 OF 1**