

DESIGN SPECIFICATIONS

ELECTRICAL	CHAN 1	CHAN 2
FREQUENCY (GHz):	14 - 14.5	DC - 2.0
VSWR (MAX):	1.3:1	1.3:1
VSWR WOW (MAX):	.1	.05
INSERTION LOSS (MAX):	.3 dB	.3 dB
POWER, AVG:	500 W	10 W
ISOLATION:	<----- 50 dB ----->	

MECHANICAL & ENVIRONMENTAL

- ROTATIONAL SPEED : 20 RPM MAX
- TEMPERATURE, OPERATING : -40° C TO +85° C
- PRESSURE : 3.5 Kpa [5 PSIG]
- LEAK RATE : < 2 CC [122 CU-IN] PER MIN
- TORQUE : 0.5 N-M [71 IN-OZ] MEASURED @ 23° C
- WEIGHT : 1.98 LBS [900 G] MAX
- MATERIAL : ALUMINUM ALLOY PRIMARILY
- FINISH : TBD
- LABEL : MASK SURFACES INDICATED BY ▽
DIAMOND STD. LABEL LOCATED WHERE SHOWN TO INCLUDE AT MIN. DIAMOND P/N

ROHS COMPLIANT

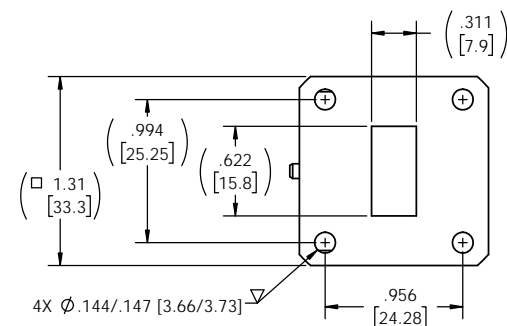
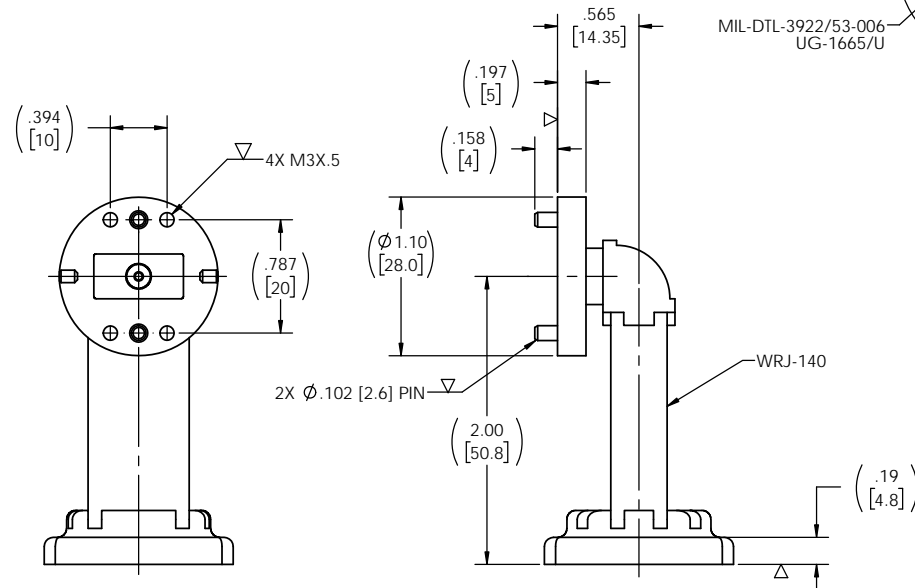

THIRD ANGLE PROJECTION		DIAMOND ANTENNA & MICROWAVE CORP LITTLETON, MA 01460	
DIMENSIONS ARE IN INCHES. REMOVE ALL BURRS AND SHARP EDGES .005 MAX, UNLESS OTHERWISE SPECIFIED. SURF FINISH 63/✓		TITLE: DUAL CHANNEL ROTARY JOINT, WR62 / SMA	
SIZE: D	CAGE CODE: 01882	DRAWING NUMBER: CAT 29-2266-0	
TOLERANCES ARE: FRACTIONS DECIMALS ANGLES 2/164 2 PLACES 2.00 1/12		SCALE: 3:2	WEIGHT (EST.):
INTERPRET DIMENSIONS & TOLERANCES PER ASME Y14.5M		SHEET 1 OF 1	