

**SPECIFICATIONS:**

	CH 1	CH 2
FREQUENCY GHz:	7.9 - 8.4	
VSWR, MAX:	1.25:1	1.40:1
VSWR WOW, MAX:	0.05	0.05
INSERTION LOSS, dB MAX:	0.3	0.4
INSERTION LOSS WOW, dB MAX:	0.05	0.05
AVERAGE POWER (W):	12	12
ISOLATION:	40 dB	
PHASE CHANGE (WOW):	1 deg	2deg
OPERATING TEMPERATURE:	-60C TO +80C	
WEIGHT, MAX:	400 g	
WEIGHT, NOM:	385 g	
TORQUE, MAX:	5 OZ-IN (.035 Nm) @ 20 C	21 OZ-IN (.15 Nm) @ -60 C
ROTATIONAL SPEED:	8 RPM	
MATERIAL:	ALUMINUM ALLOY PRIMARILY	
FINISH:	CHROMATE CONVERSION COAT PER MIL-DTL-5541, CLASS 3	

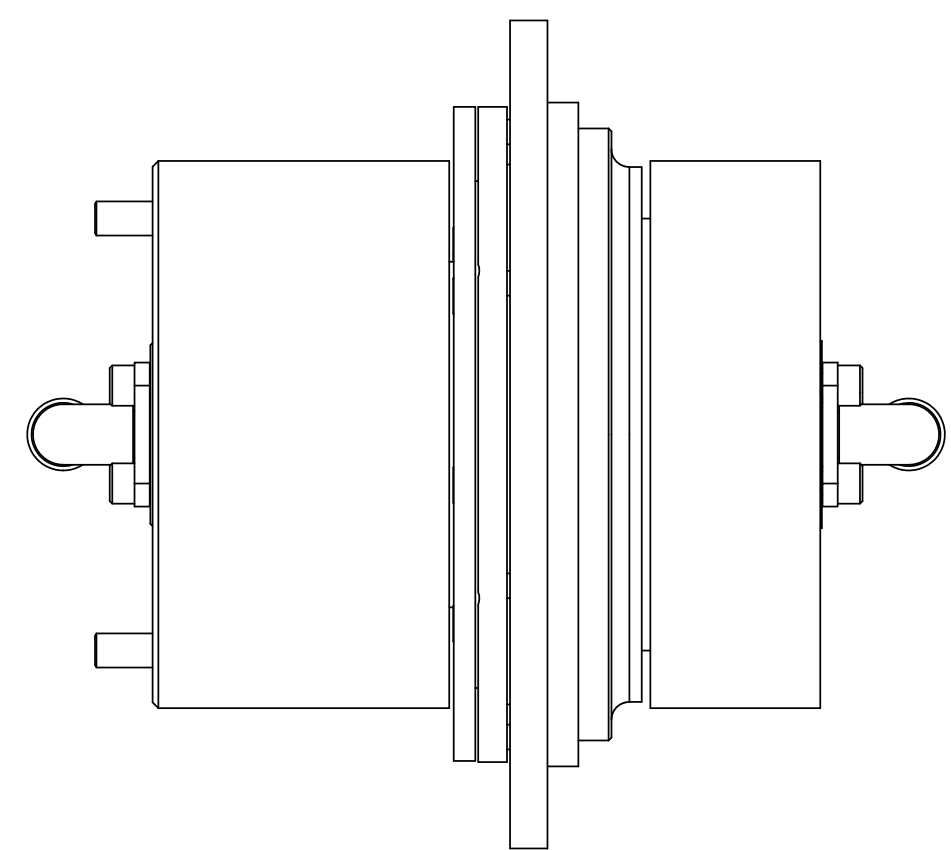

THIRD ANGLE PROJECTION

DIMENSIONS ARE IN INCHES.  
REMOVE ALL BURRS AND  
SHARP EDGES .005 MAX,  
UNLESS OTHERWISE  
SPECIFIED. SURF FINISH 63  
TOLERANCES ARE:  
FRACTIONS DECIMALS ANGLES  
±1/64 2 PLACES ±.03 ±1/2°  
±1/32 3 PLACES ±.010

INTERPRET DIMENSIONS &  
TOLERANCES PER ASME Y14.5M

<b>DIAMOND ANTENNA &amp; MICROWAVE CORP</b> LITTLETON, MA 01460		
TITLE: <b>DUAL CHANNEL NON-CONTACTING ROTARY JOINT</b>		
SIZE: <b>C</b>	CAGE CODE: <b>01882</b>	DRAWING NUMBER: <b>CAT 118-2255-0</b>
SCALE <b>1.5:1</b>	WEIGHT (EST.):	SHEET <b>1 OF 1</b>