

ENCODER NOT SHOWN  
THIS VIEW

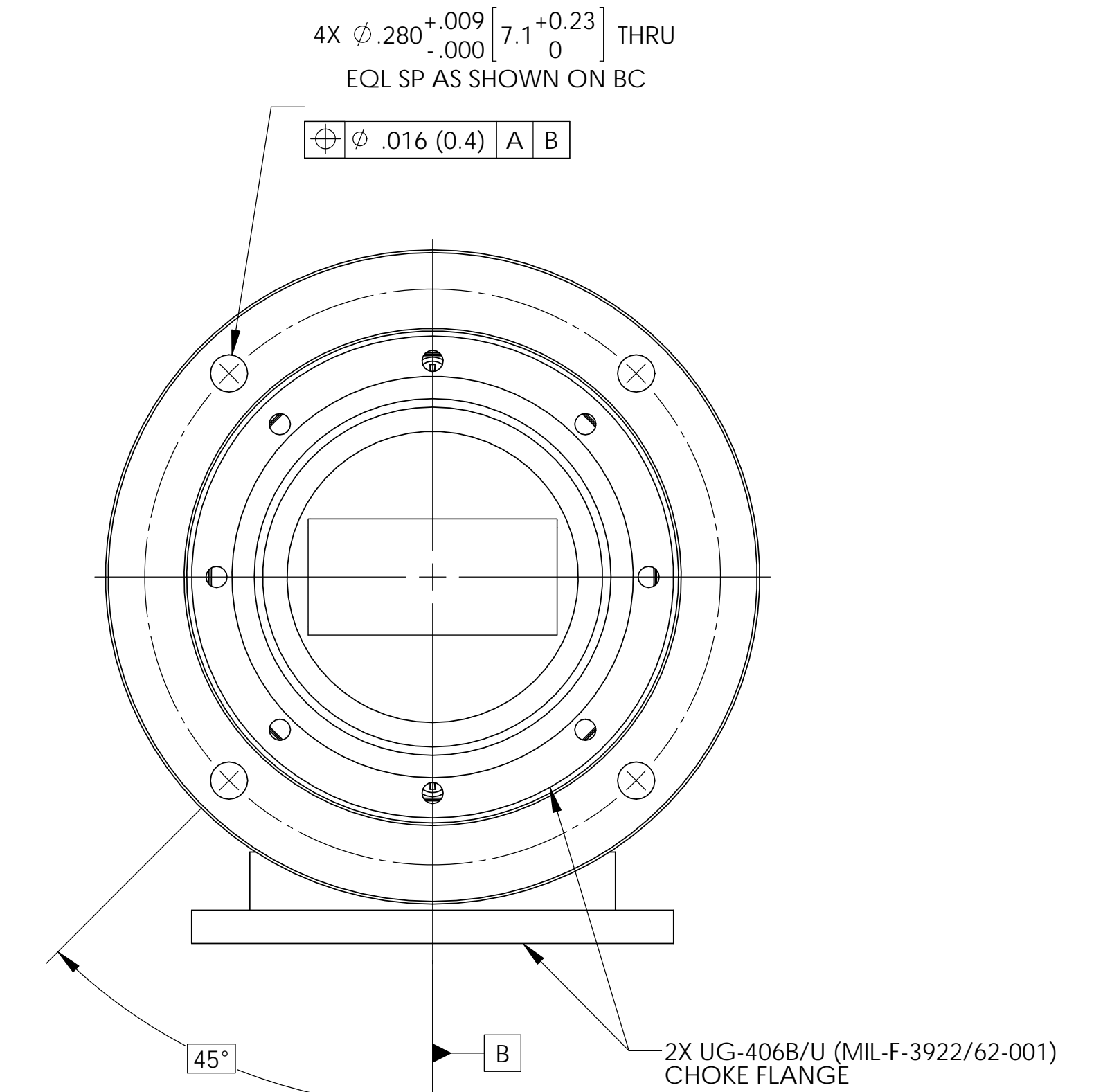
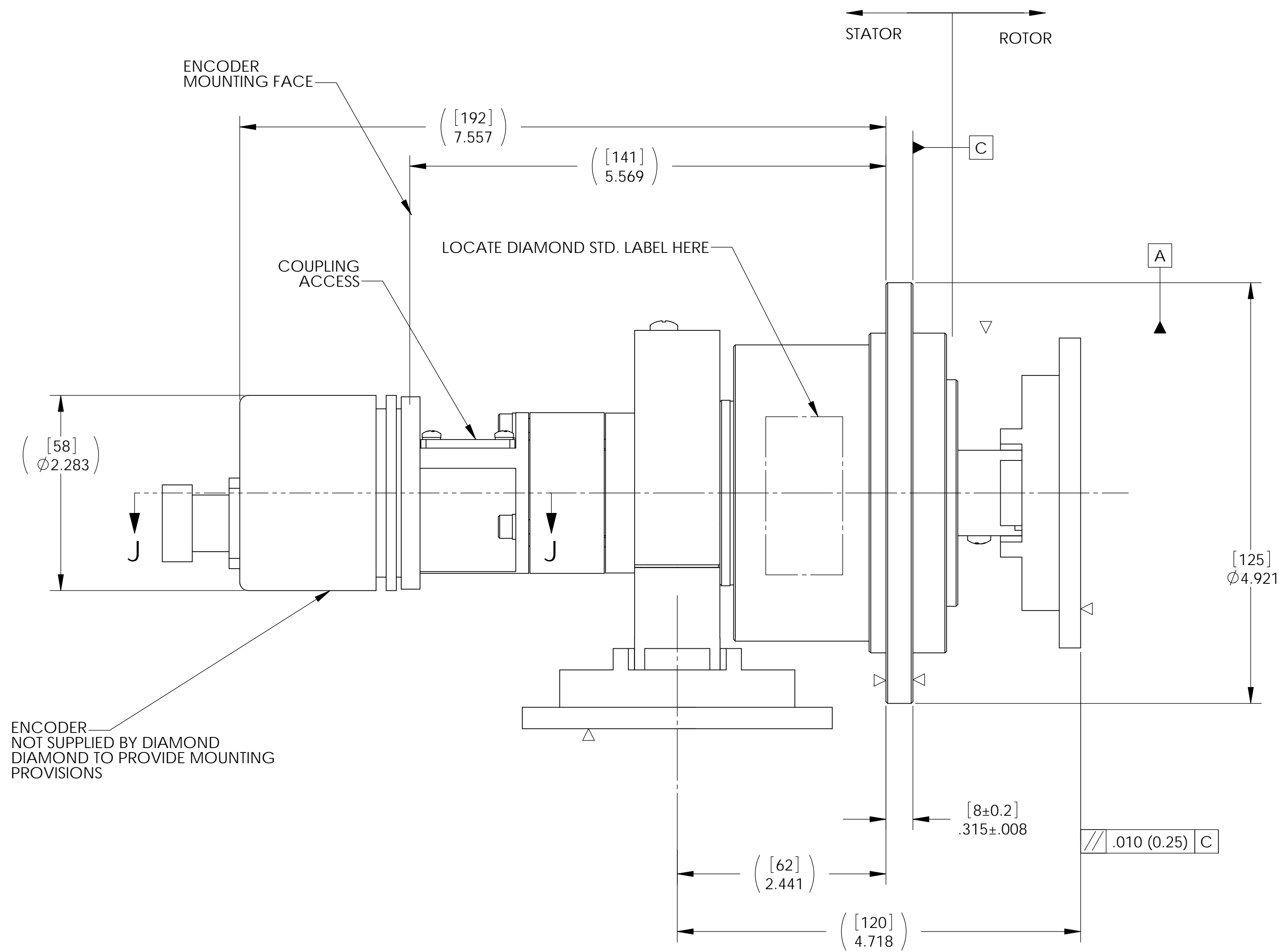

**SPECIFICATIONS - ROTARY JOINT:**

	<b>WR-187 WAVEGUIDE CHANNEL</b>
FREQUENCY (GHz):	5.4-5.8
VSWR (MAX.):	1.15:1
VSWR WOW (MAX.):	0.05
INSERTION LOSS (dB) (MAX.):	0.15
INSERTION LOSS WOW:	<±0.05dB
PEAK POWER (KW):	350
AVERAGE POWER (W):	600

**SPECIFICATIONS - MECHANICAL/ENVIRONMENTAL:**

PRESSURIZATION:	10 PSIG (0.07 Mpa) MINIMUM, 15 PSIG (0.10 Mpa) PREFERRED
LEAK RATE:	5 CC/MINUTE MAX.
TORQUE:	13.3 IN-LB MAX. (1.5 Nm)
ROTATION RATE:	60 RPM
WEIGHT:	5.51 LBS (2.5 KG)
TEMPERATURE RANGE:	-40°C TO +85°C (OPERATING) -70°C TO +125°C (STORAGE)
BASIC MATERIAL:	ALUMINUM ALLOY
FINISH:	TBD

**LABEL:**

LABEL IS TO INCLUDE THE FOLLOWING AS A MINIMUM:  
PT# 45-546-0  
S/N: \_\_\_\_\_

**RoHs COMPLIANT**

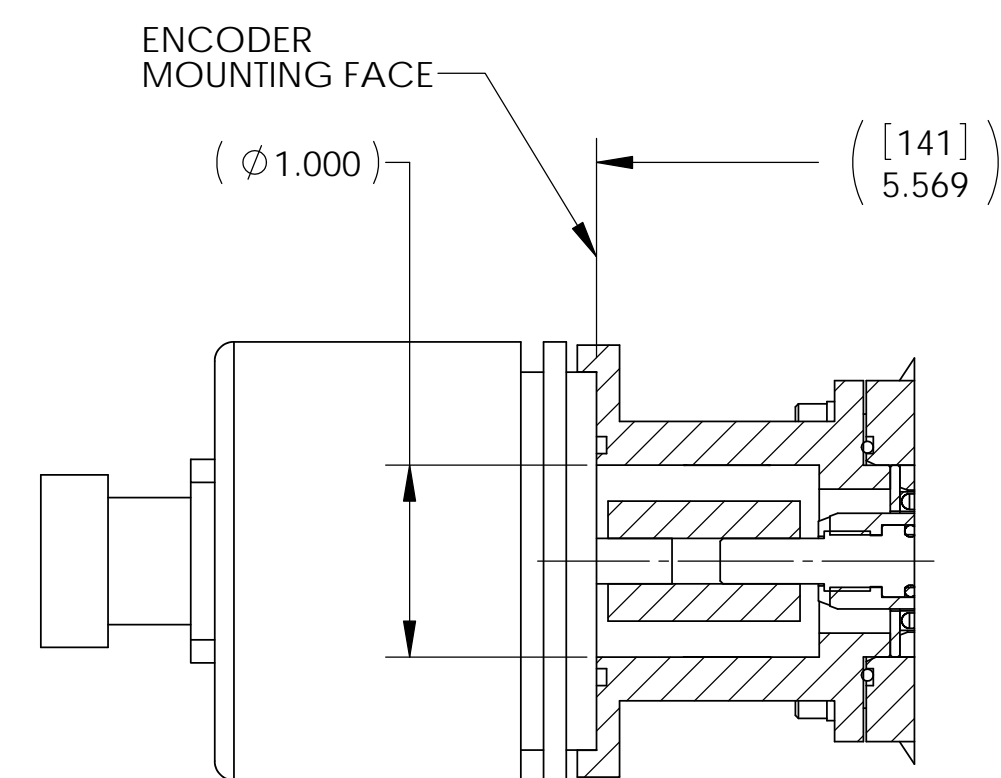

SECTION J-J

THIRD ANGLE PROJECTION		DIAMOND ANTENNA & MICROWAVE CORP LITTLETON, MA 01460	
		TITLE: ROTARY JOINT, WR187, "L" STYLE	
<small>DIMENSIONS ARE IN INCHES. REMOVE ALL BURRS AND SHARP EDGES .005 MAX. UNLESS OTHERWISE SPECIFIED. SURF. FINISH 63. TOLERANCES ARE:</small>		SIZE: D	DRAWING NUMBER: CAT 45-546-0
<small>FRACTIONS DECIMALS ANGLES 2 PLACES ±.01 10°</small>		CAGE CODE: 01882	WEIGHT (EST.):
<small>INTERPRET DIMENSIONS &amp; TOLERANCES PER ASME Y14.5M</small>		SCALE: 1:1	SHEET 1 OF 1